

ALUMINUM COUPLERS

TYPE ALB90

90° Angle Bolted

Pipe Main to Pipe Tap

Aluminum alloy angle coupler for aluminum pipe connections at 90°. Clamping bolts have hex-stops for one wrench installation. Contact sealant is recommended.

Casting Alloy: 356-T6 Aluminum
Clamping Hardware: Aluminum Alloy

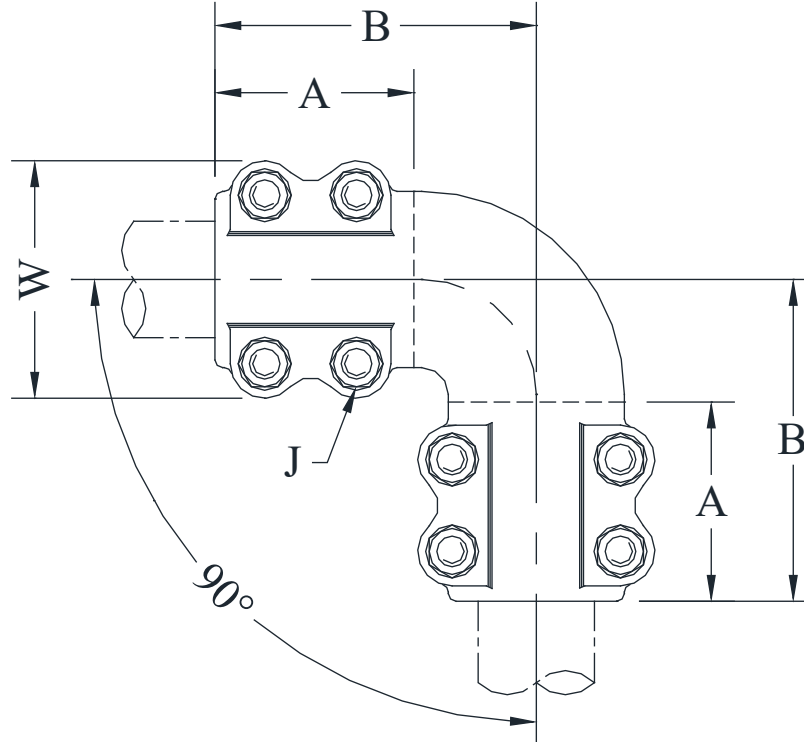

CATALOG NUMBER	CONDUCTOR SIZE (NPS)		DIMENSIONS - INCHES				WEIGHT (POUNDS)
	PIPE MAIN	PIPE TAP	A	B	W	J	
ALB90-3030	3/4	3/4	2-1/2	3-15/16	3	1/2	1.80
ALB90-3939	1	1	2-3/4	4-7/8	3-1/4	1/2	2.20
ALB90-4949	1-1/4	1-1/4	3	4-3/4	3-5/8	1/2	3.60
ALB90-5353	1-1/2	1-1/2	3-5/16	5	3-7/8	1/2	4.50
ALB90-5858	2	2	3-9/16	5-1/2	4-3/8	1/2	5.60
ALB90-6060	2-1/2	2-1/2	3-5/8	6-1/4	4-3/4	1/2	8.40
ALB90-6262	3	3	4-1/8	6-3/8	5-7/8	5/8	10.70
ALB90-6363	3-1/2	3-1/2	4-3/8	6-7/8	6-3/8	5/8	12.00
ALB90-6464	4	4	4-1/4	7-15/16	7	5/8	16.00
ALB90-6767	5	5	7	11-1/4	7-7/8	5/8	37.15